

Coils and Electronics

J series

23W ToughCoil

■ PERFORMANCE DATA

Duty cycle	100% at 110% of rated voltage
Magnet wire insulation	U.L. class N, 200°C [392°F] NEMA pub. No. MW 1000, section MW 35 – C [single]
Ambient temperature	100°C [212°F] continuous @ rated voltage
Input Voltage Range	85% to 110% of rated voltage
UL Rated (certificate available upon request)	

■ ENVIRONMENT PROTECTION

Rating	Connector Type
IP65	G0*
IP67	Y0, W0
IP69K	NO, DO, JO
Thermal shock dunk	W0 ¹ , NO, DO, JO

¹Passed environmental testing, but not as robust as other connectors

*Rating dependent on mating connector

■ ELECTRICAL SPECIFICATIONS

Voltage	12 DC	24 DC	115 AC	230 AC
Current (A)	1.92	0.96	0.22	0.11
Power (W)	23	23	23	23

*Nominal voltage 25°C (77°F).

Diode Information

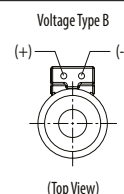

Flyback diode (arc suppressor), maximum recurrent peak reverse voltage - 800V

■ MODEL CODE

MCSC - J - 012 - D - G0 - 0 - 00 - 10

Coil Series
J - Size 10, 12, 16, 20 [210 Bar]

Coil Voltage

Code	Coil Voltage
012	12 volt
024	24 volt
115	115 volt
230	230 volt

Voltage Type
D - DC
B - DC/with flyback diode
A - AC/with full bridge rectifier

Lead Length
0 - None
A - 152mm [6.0 in] (Standard length with connector)
B - 610mm [24.0 in] (Standard length without connector)

Connector Type
G0 - ISO 4400 DIN 43650
Q0 - Spade terminals
W0 - Flying lead
NO - Deutsch (DC only)
YO - Amp JR (DC only)
DO - Metripack 150 male (DC only)
JO - Metripack 280 male (DC only)

■ PART NUMBERS - (300AA00_____ - COMPLETE PART NUMBER IS 11 DIGITS)

Voltage	G0** Connector	Q0 Connector	W0 Connector	NO Connector	YO Connector	DO Connector	JO Connector
12VDC	081A	089A	095A	101A	106A	111A	116A
24VDC	082A	090A	096A	102A	107A	112A	117A
115VAC	085A						
230VAC	086A						
12VDC*	087A	093A	099A	104A	109A	114A	119A
24VDC*	088A	094A	100A	105A	110A	115A	120A

*With flyback diode. (Voltage Type B)

**DIN 43560 mating connector for "G0" style coil – 02-166796 or AXP14116.

Coils and Electronics

J series

23W ToughCoil

■ DIMENSIONS

mm [in]

G0
DIN 43650

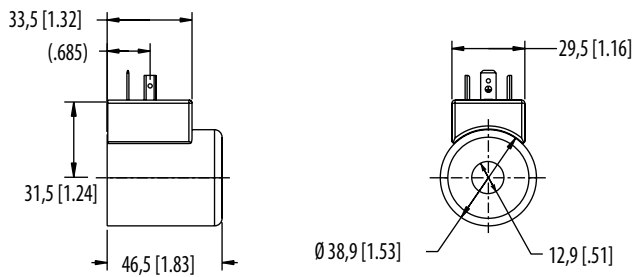

Q0
Spade connector

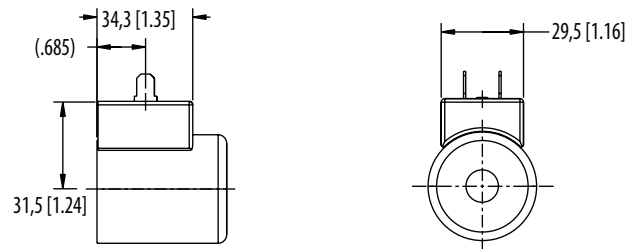

W0
Leadwire

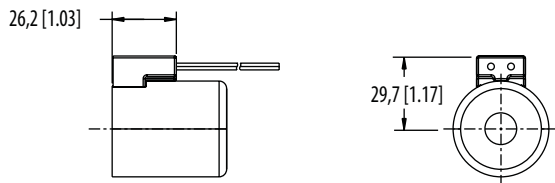

N0
Deutsch male DT04-2P integrated connector

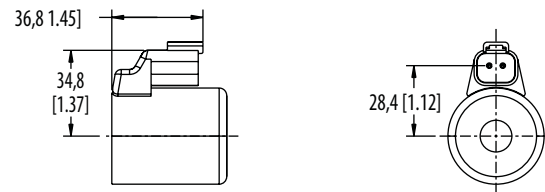

Y0
AMP Junior timer integrated connector

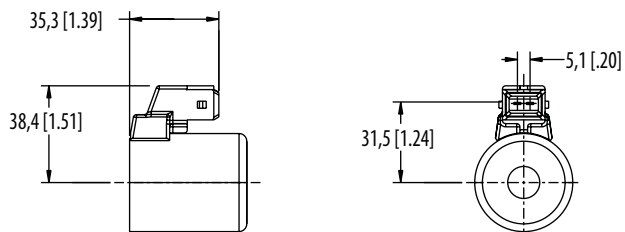

D0
Metri-Pack 150 Male, integrated connector

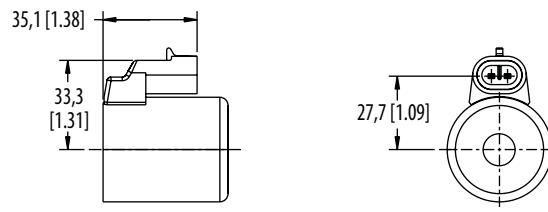

J0
Metri-Pack 280 Male, integrated connector

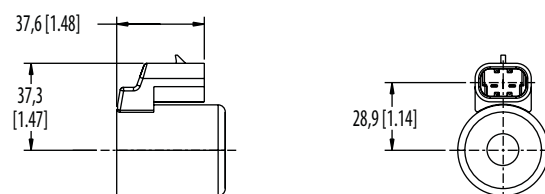

Coils and Electronics

S series

20W ToughCoil

■ PERFORMANCE DATA

Duty cycle	100% at 110% of rated voltage
Magnet wire insulation	U.L. class N, 200°C [392°F] NEMA pub. No. MW 1000, section MW 35 – C [single]
Ambient temperature	100°C [212°F] continuous @ rated voltage
Input Voltage Range	85% to 110% of rated voltage
UL Rated (certificate available upon request)	

■ ENVIRONMENT PROTECTION

Rating	Connector Type
IP65	G0*
IP67	Y0, W0
IP69K	NO, DO, JO
Thermal shock dunk	W0 ¹ , NO, DO, JO

¹Passed environmental testing, but not as robust as other connectors

*Rating dependent on mating connector

■ ELECTRICAL SPECIFICATIONS

Voltage	12 DC	24 DC	115 AC	230 AC
Current (A)	1.67	0.83	0.19	0.10
Power (W)	20	20	20	20

*Nominal voltage 25°C (77°F).

Diode Information

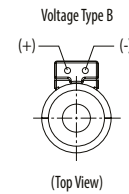

Flyback diode (arc suppressor), maximum recurrent peak reverse voltage - 800V

■ MODEL CODE

MCSC - S - 012 - D - G0 - 0 - 00 - 10

Coil Series
S - Size 8 [210 bar]

Coil Voltage

Code	Coil Voltage
012	12 VDC
024	24 VDC
115	115 VAC
230	230 VAC

Voltage Type
D - DC
B - DC/with flyback diode
A - AC/with full bridge rectifier

Lead Length
0 - None
A - 152mm [6.0 in] (Standard length with connector)
B - 610mm [24.0 in] (Standard length without connector)

Connector Type
G0 - ISO 4400 DIN 43650
Q0 - Spade terminals
W0 - Flying lead
NO - Deutsch (DC only)
Y0 - Amp JR (DC only)
DO - Metripack 150 male (DC only)
JO - Metripack 280 male (DC only)

■ PART NUMBERS (300AA00 ____ - COMPLETE PART NUMBER IS 11 DIGITS)

Voltage	G0** Connector	Q0 Connector	W0 Connector	NO Connector	Y0 Connector	DO Connector	JO Connector
12VDC	001A	009A	015A	021A	026A	031A	036A
24VDC	002A	010A	016A	022A	027A	032A	037A
115VAC	005A						
230VAC	006A						
12VDC*	007A	013A	019A	024A	029A	034A	039A
24VDC*	008A	014A	020A	025A	030A	035A	040A

*With flyback diode. (Voltage Type B)

**DIN 43560 mating connector for "G0" style coil – 02-166796 or AXP14116.

Coils and Electronics

S series

20W Standard Coil

■ DIMENSIONS

mm [in]

G0
DIN 43650

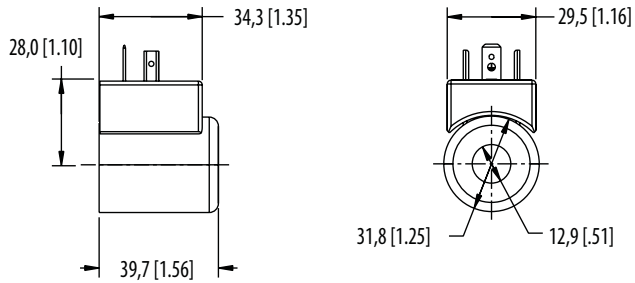

Q0
Spade connector

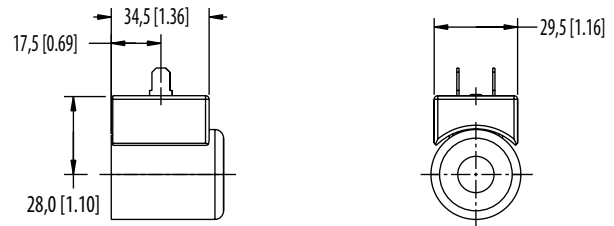

W0
Leadwire

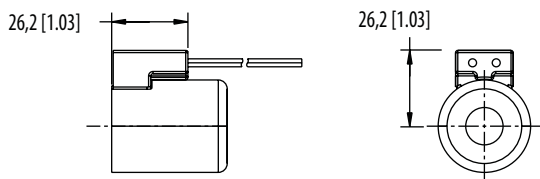

N0
Deutsch Male DT04-2P

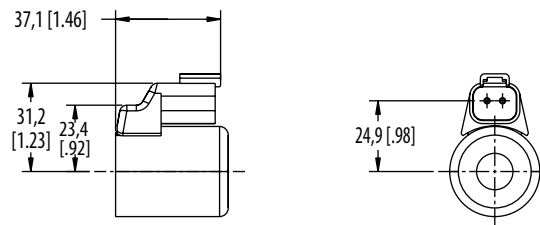

Y0
AMP Junior

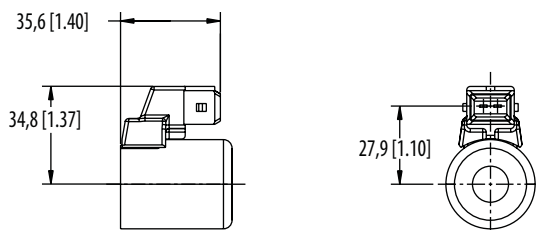

D0
Metri-Pack 150 Male

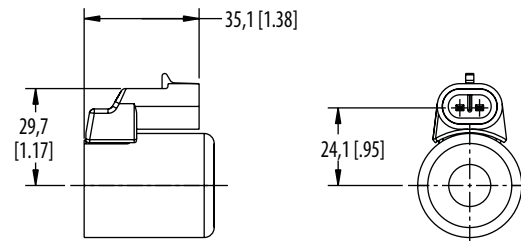

J0
Metri-Pack 280 Male

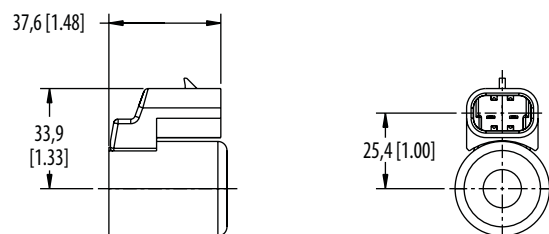

Coils and Electronics

P series

23W ToughCoil

PERFORMANCE DATA

Duty cycle	100% at 110% of rated voltage
Magnet wire insulation	U.L. class N, 200°C [392°F] NEMA pub. No. MW 1000, section MW 35 – C [single]
Ambient temperature	100°C [212°F] continuous @ rated voltage
Input Voltage Range	85% to 110% of rated voltage
UL Rated (certificate available upon request)	

ENVIRONMENT PROTECTION

Rating	Connector Type
IP65	G0*
IP67	Y0, W0
IP69K	NO, DO, JO
Thermal shock dunk	W0, NO, DO, JO

*Passed environmental testing, but not as robust as other connectors

*Rating dependent on mating connector

ELECTRICAL SPECIFICATIONS

Voltage	12 DC	24 DC	115 AC	230 AC
Current (A)	1.92	0.96	0.22	0.11
Power (W)	23	23	23	23

*Nominal voltage 25°C (77°F).

Diode Information

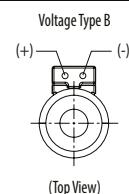

Flyback diode
(arc suppressor),
maximum recurrent
peak reverse voltage
- 800V

MODEL CODE

MCSC - P - 012 - D - NO - 0 - 00 - 10

Coil Series

P - Size 8 [350 Bar]

Coil Voltage

Code	Coil Voltage
012	12 VDC
024	24 VDC
115	115 VAC
230	230 VAC

Voltage Type

D - DC
B - DC/with flyback diode
A - AC/with full bridge rectifier

Lead Length

0 - None
A - 152mm [6.0 in]
(Standard length with connector)
B - 610mm [24.0 in]
(Standard length with connector)

Connector Type

G0 - ISO 4400 DIN 43650
Q0 - Spade terminals
W0 - Flying lead
NO - Deutsch (DC only)
YO - Amp JR (DC only)
DO - Metripack 150 male (DC only)
JO - Metripack 280 male (DC only)

PART NUMBERS (300AA00_____ - COMPLETE PART NUMBER IS 11 DIGITS)

Voltage	G0** Connector	Q0 Connector	W0 Connector	NO Connector	YO Connector	DO Connector	JO Connector
12VDC	041A	049A	055A	061A	066A	071A	076A
24VDC	042A	050A	056A	062A	067A	072A	077A
115VAC	045A						
230VAC	046A						
12VDC*	047A	053A	059A	064A	069A	074A	079A
24VDC*	048A	054A	060A	065A	070A	075A	080A

*With flyback diode. (Voltage Type B)

**DIN 43560 mating connector for "G0" style coil – 02-166796 or AXP14116.

Coils and Electronics

P series

23W ToughCoil

■ DIMENSIONS

mm [in]

G0
DIN 43650

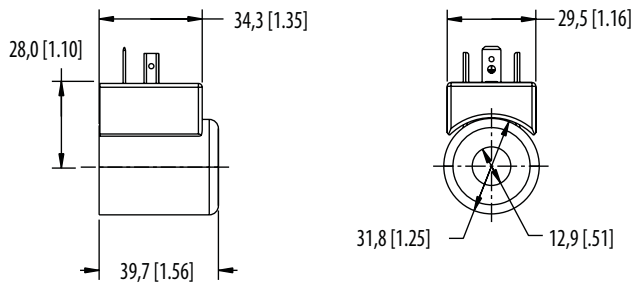

Q0
Spade connector

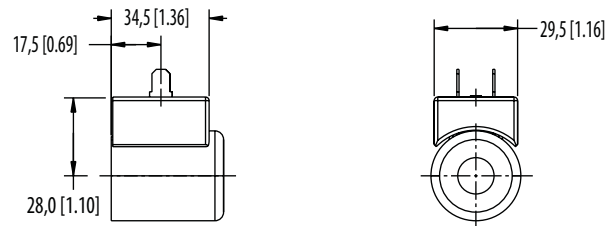

W0
Leadwire

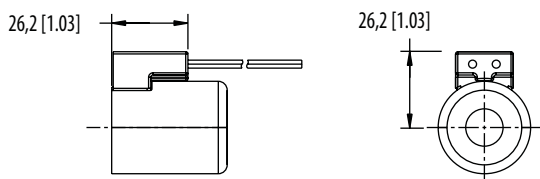

N0
Deutsch Male DT04-2P

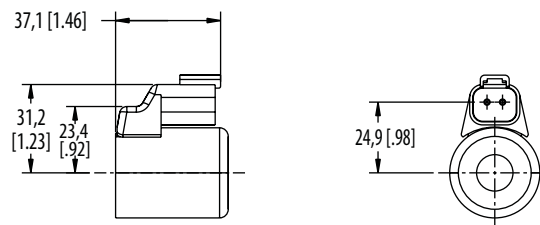

Y0
AMP Junior

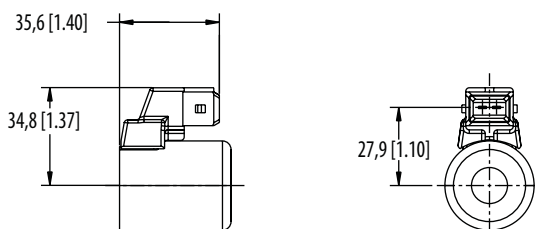

D0
Metri-Pack 150 Male

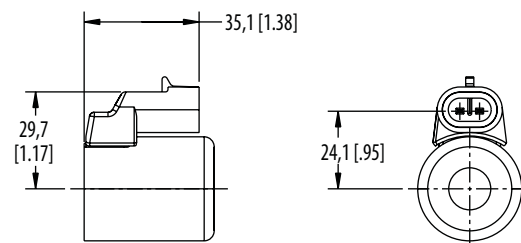

J0
Metri-Pack 280 Male

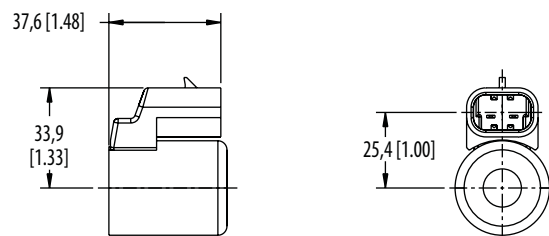

Coils and Electronics

H series

29W ToughCoil

■ PERFORMANCE DATA

Duty cycle	100% at 110% of rated voltage
Magnet wire insulation	U.L. class N, 200°C [392°F] NEMA pub. No. MW 1000, section MW 35 – C [single]
Ambient temperature	100°C [212°F] continuous @ rated voltage
Input Voltage Range	85% to 110% of rated voltage
UL Rated (certificate available upon request)	

■ ENVIRONMENT PROTECTION

Rating	Connector Type
IP65	G0*
IP67	Y0, W0
IP69K	NO, DO, JO
Thermal shock dunk	W0 ¹ , NO, DO, JO

¹Passed environmental testing, but not as robust as other connectors

*Rating dependent on mating connector

■ ELECTRICAL SPECIFICATIONS

Voltage	12 DC	24 DC	115 AC	230 AC
Current (A)	2.42	1.21	0.28	0.14
Power (W)	29	29	29	29

*Nominal voltage 25°C (77°F).

Diode Information

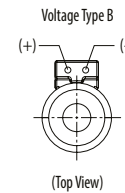

Flyback diode (arc suppressor), maximum recurrent peak reverse voltage - 800V

■ MODEL CODE

MCSC - H - 012 - D - W0 - A - 00 - 10

Coil Series

H - Size 10, 12, 16, 20 [350 Bar]

Coil Voltage

Code	Coil Voltage
012	12 volt
024	24 volt
115	115 volt
230	230 volt

Voltage Type

D - DC
B - DC/with flyback diode
A - AC/with full bridge rectifier

Lead Length

0 - None
A - 152mm [6.0 in]
(Standard length with connector)
B - 610mm [24.0 in]
(Standard length without connector)

Connector Type

G0 - ISO 4400 DIN 43650
Q0 - Spade terminals
W0 - Flying lead
NO - Deutsch (DC only)
Y0 - Amp JR (DC only)
DO - Metripack 150 male (DC only)
JO - Metripack 280 male (DC only)

■ PART NUMBERS - (300AA00_____ - COMPLETE PART NUMBER IS 11 DIGITS)

Voltage	G0** Connector	Q0 Connector	W0 Connector	NO Connector	Y0 Connector	DO Connector	JO Connector
12VDC	121A	129A	135A	141A	146A	151A	156A
24VDC	122A	130A	136A	142A	147A	152A	157A
115VAC	125A	–	–	–	–	–	–
230VAC	126A	–	–	–	–	–	–
12VDC*	127A	133A	139A	144A	149A	154A	159A
24VDC*	128A	134A	140A	145A	150A	155A	160A

*With flyback diode. (Voltage Type B)

**DIN 43560 mating connector for "G0" style coil – 02-166796 or AXP14116.

Coils and Electronics

H series

29W ToughCoil

■ DIMENSIONS

mm [in]

G0
DIN 43650

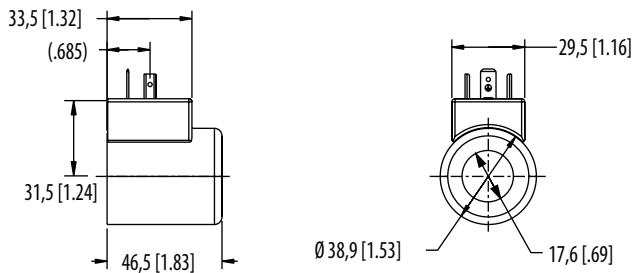

Q0
Spade connector

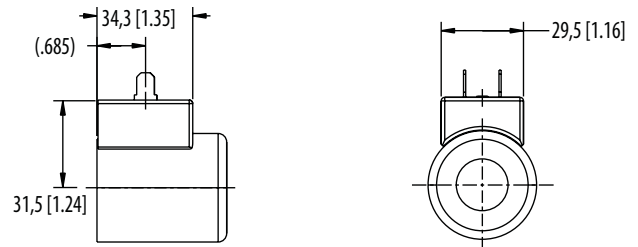

W0
Leadwire

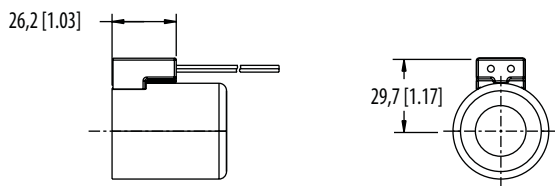

N0
Deutsch male DT04-2P integrated connector

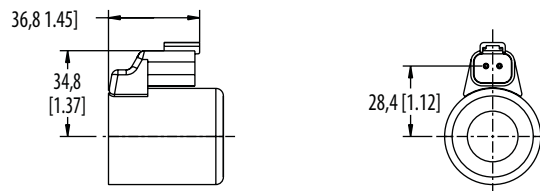

Y0
AMP Junior timer integrated connector

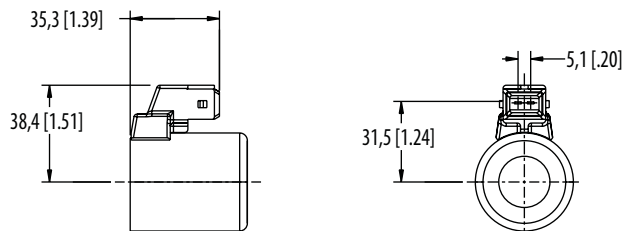

D0
Metri-Pack 150 Male, integrated connector

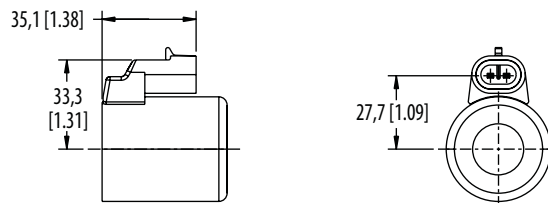

J0
Metri-Pack 280 Male, integrated connector

